

AGILE X 3

UNISA PAVILION 2016

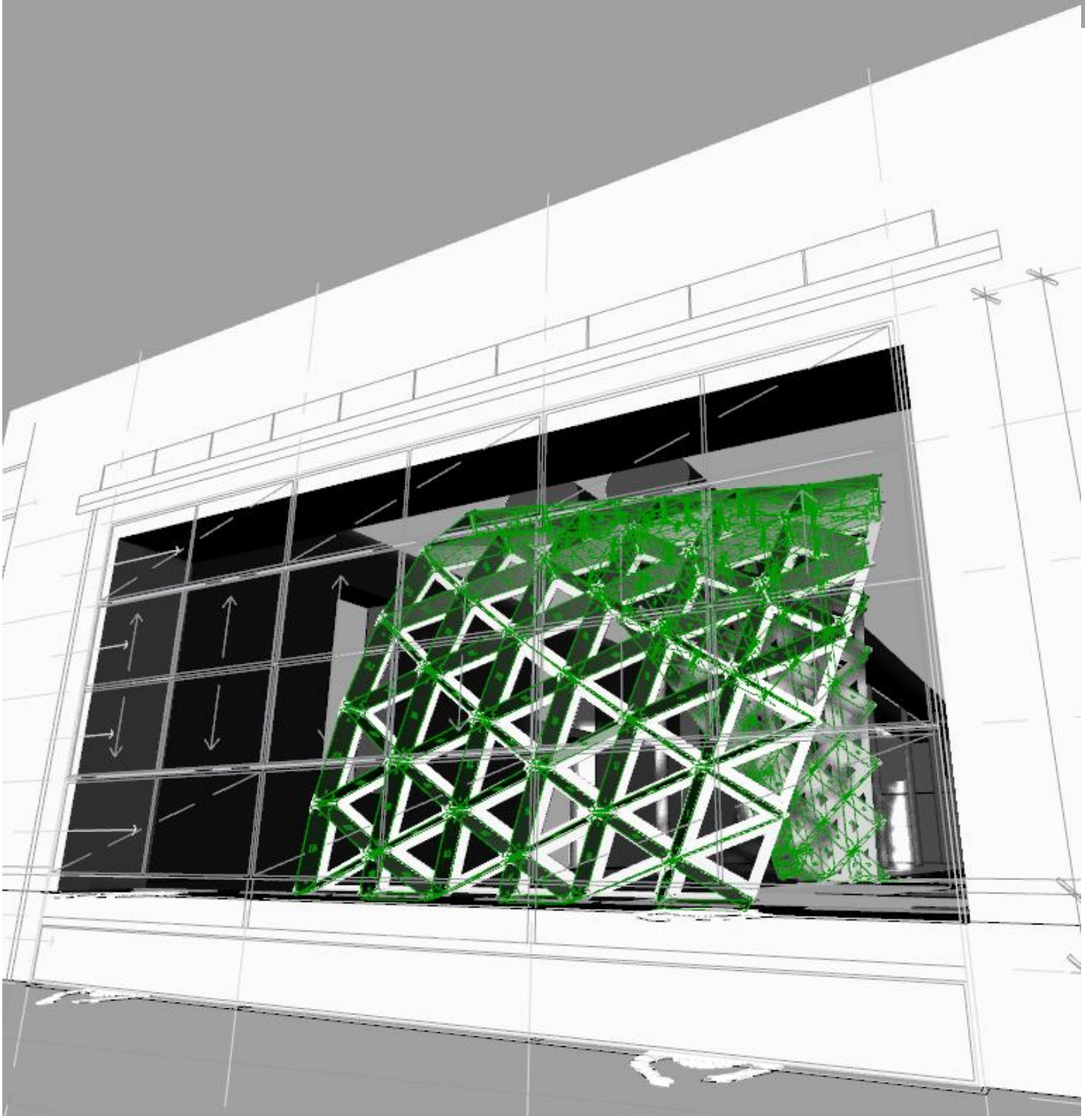

[Type here]

BUIL 2024 CONSTRUCTION IN THE WORKSHOP BUIL 5040 CONSTRUCTION IN THE WORKSHOP ADVANCED

WELCOME TO AGILE X 3

On 26th April you are invited to attend the opening of the Agile X UniSA pavilion at ODASA on Leigh Street.

The pavilion builds upon two previous electives held in TU Delft in September 2015 and at UniSA in January this year.

PARTNERS



[Type here]

BUIL 2024 CONSTRUCTION IN THE WORKSHOP BUIL 5040 CONSTRUCTION IN THE WORKSHOP ADVANCED

PREVIOUSLY ON AGILE X

At Agile X 1 at TU Delft in the Netherlands we imagined how we could draw and control a building without describing anything material or physical about the building. In this way we hoped that this would allow us to be flexible / agile about our material choices for the building.

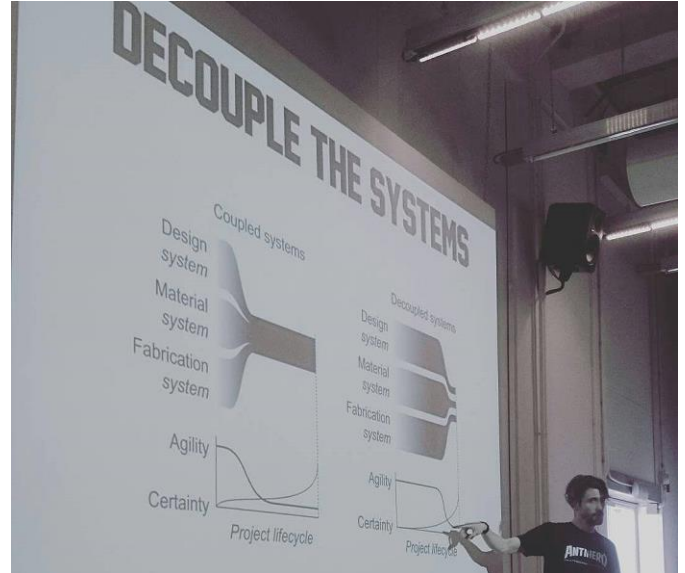

The purpose of this exercise is so that we can not always know what will happen in a project with great material and economic uncertainty, so we choose to separate the material from the 'immaterial' design. We then design 3 immaterial pavilions for Adelaide, Delft and Tianjin.

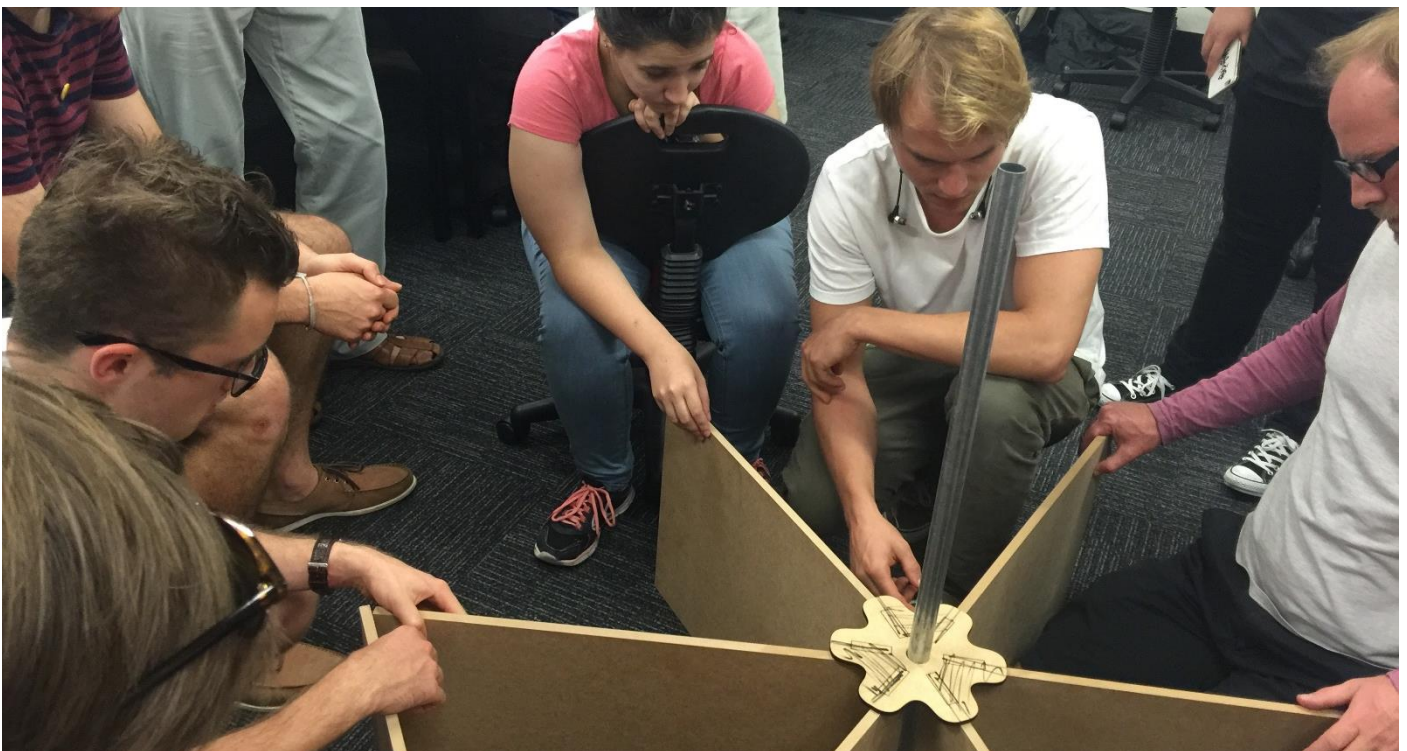

Following on from the

[Type here]

AGILE X 3

NOW ITS UP TO YOU TO FINISH THE BUILD IN TIME FOR THE OPENING ON THE 26TH APRIL

To achieve this we will invert the normal digital design and fabrication process by starting with the construction of structure. You will then use this hands on construction in the workshop experience to inform the design of the panels for the pavilion. In addition each group will be tasked group specific additional tasks each week.

You will split into 8 groups of 4 people, roughly 2 engineers and 2 architects per group.

CONSTRUCTION IN THE WORKSHOP BUIL 2024

Task	Equivalent length	Weighting
Journal	450 words	10 %
Construction Assignment	3150 words	70 %
Documentation Assignment	900 words	20 %

CONSTRUCTION IN THE WORKSHOP. ADVANCED BUIL 5040

Task	Equivalent length	Weighting
Journal	450 words	10 %
Construction Assignment	3600 words	80 %
Documentation Assignment	450 words	10 %

Journal : individual blogs on the process. Please see Misbah's Agile X blog for a good example. Misbah completed the previous Agile X workshop in January <http://agilexpavilion2016.blogspot.com.au/>

Construction Assignment: constructing the pavilion

Documentation Assignment: Group specific task (I.e. loading, BCA code compliance, construction sequence)

Note it is also important to document the process please take photos / videos. On Instagram please mention

@morphotype and @unisa.architecture

Its going to be hard, but its going to be worth it 😊

[Type here]

BUIL 2024 CONSTRUCTION IN THE WORKSHOP BUIL 5040 CONSTRUCTION IN THE WORKSHOP ADVANCED

AGILE X 3 PROGRAMME

WEEK 1

Group	Mon A	Mon P	Tue A	Tue P	Wed A	Wed P	Thur A	Thur P	Fri A	Fri P
1	Paint x 2	Construct sequence	Paint x2	Panel design	GH training	Assemble	GH training	Panel design	White Card	LB
2	Paint x 2	Construct sequence	Paint x2	Panel design	GH training	Assemble	GH training	Panel design	White Card	LB
3	Paint x 2	Construct sequence	Paint x2	Panel design	GH training	Assemble	GH training	Panel design	White Card	LB
4	Load calculations	Load calculations	Paint x2	Panel design	GH training	Assemble	GH training	Panel design	White Card	LB
5	Load calculations	Load calculations	Paint x2	Panel design	GH training	Assemble	GH training	Panel design	White Card	LB
6	Waffle Nesting	Waffle Nesting	Paint x2	Panel design	GH training	Assemble	GH training	Panel design	White Card	LB
7	BCA Compliance	BCA Compliance	Paint x2	Panel design	GH training	Assemble	GH training	Panel design	White Card	LB
8	Exhibition planning	Exhibition planning	Paint x2	Panel design	GH training	Assemble	GH training	Panel design	White Card	LB

WEEK 2

Grp	Mon A	Mon P	Tue A	Tue P	Wed A	Wed P	Thur A	Thur P	Fri A	Fri P
1	Panel design	Panel design	Construct sequence	Panel proto-type	Fab panels	Fab panels	Assemble panels	Assemble panels	Finalise	Finalise
2	Panel design	Panel design	Construct sequence	Panel proto-type	Fab panels	Fab panels	Assemble panels	Assemble panels	Finalise	Finalise
3	Panel design	Panel design	Panel proto-type	Panel proto-type	Fab panels	Fab panels	Assemble panels	Assemble panels	Finalise	Finalise
4	Panel design	Panel design	Panel proto-type	Panel proto-type	Fab panels	Fab panels	Assemble panels	Assemble panels	Finalise	Finalise
5	Material Analysis	Material Analysis	Material Analysis	Material Analysis	Fab Plinths	Fab Plinths	Assemble Plinths	Assemble panels	Finalise	Finalise
6	Material Analysis	Material Analysis	Material Analysis	Material Analysis	Fab Plinths	Fab Plinths	Assemble Plinths	Assemble panels	Finalise	Finalise
7	Exhibit planning	Exhibit planning	Exhibit planning	Exhibit planning	Fab panels	Fab panels	Assemble panels	Assemble panels	Finalise	Finalise
8	Exhibit planning	Exhibit planning	Exhibit planning	Exhibit planning	Fab panels	Fab panels	Assemble panels	Assemble panels	Finalise	Finalise

[Type here]

STRUCTURE

Paint the 2400 x 1200 x 6mm MDF panels in the workshop

Waffle Nesting: Using Rhino arrange the generated components onto panels for cutting and printing (training provided). This process generates two files the print file which contains the number of the panels and the cut file which contains the outlines of all the panels.

Flat bed printing: provide the a nested panel file to Shane Haddy in the workshop

CNC 3 Axis routing: The

Component assembly offsite in the workshop

Super component assembly onsite (Monday 18th April)

PANELS

Grasshopper tuition provided to enable the groups to develop their own panel proposals

Design the panels based on the base design developed in the AGILE X 2 in January

Prototype the test panels and refine the design accordingly

Fabricate the final panels

Install the panels in the finalised structure in ODASA.

EXHIBITION

Develop and **curate exhibits** (includes prototypes, drawings and models from AGILE X 1 and 2)

Produce **plinths** for the exhibition

Install all exhibits for the exhibition

[Type here]

BUIL 2024 CONSTRUCTION IN THE WORKSHOP BUIL 5040 CONSTRUCTION IN THE WORKSHOP ADVANCED